

TACMINA

Chemical Injection System

PTS





All the chemical injection functions packed into one unit.

This chemical injection system combines a high-performance pump and multi-function tank to deliver the ultimate in usefulness and safety. When it is used in combination with a pump featuring a timer control function, the scope of its applications becomes even wider.

Chemical Injection System **PTS**

Easy to use and extremely convenient

Level gauge with simplified metering function

1

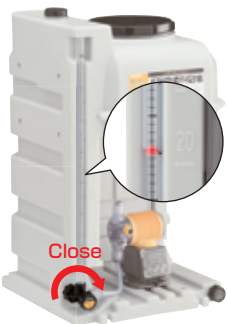

Simply by closing the suction valve and shutting off the supply of the chemicals in the tank, the pump's discharge volume can be checked using the level gauge while keeping the pipes connected.

Reduce the volume of the wasted chemical liquids

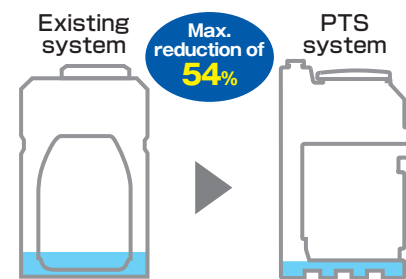

The volume of the wasted chemical liquids is reduced by incorporating shapes for the bottom of the tank and for the suction valve position, etc. that minimize the level of the chemical liquids remaining.

Enough space provided to access the pump

2



Sufficient space has been provided around the pump to facilitate both operation and maintenance. Two pumps can be incorporated.*1

Easy to maintain

3

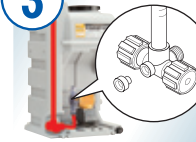

The system is equipped with a drain as a standard feature that purges the remaining liquid in the suction side pipe when the pump is to be removed.

Easy installation

4



The system has a special groove for neatly storing the hose.*1

5



Pump cover that is easy to put in place

6

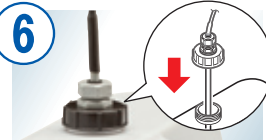

A float switch (option) can easily be installed as well.

7



Air-release hose insertion slot into which the hose can easily be inserted

8



Insert nuts provided for installing options*2

Tank variations



Installed pumps

Model exclusively for sodium hypochlorite injection

Model for general chemical liquid injection



NEW

DCLPW

- Air-block mechanism
- In-line type automatic air-release mechanism
- Acrylic head that makes air visible



NEW

CLPW

- In-line type automatic air-release mechanism
- Acrylic head that makes air visible



NEW

PW

- 3 types of injection control: Pulse signal control, Analog signal control, Timer control

Other pumps installed: PZ, PZD, PZI, CSII, SXDA

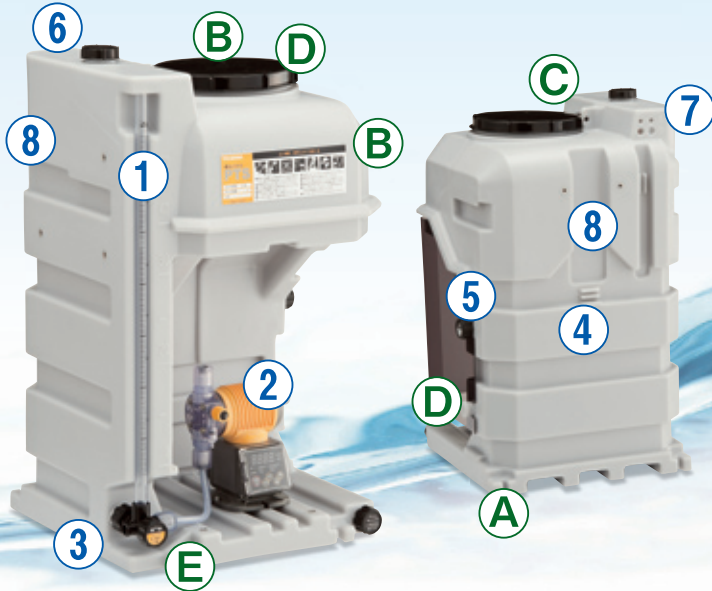

Definitive anti-gas locking design for injecting sodium hypochlorite

The trouble experienced in the past when injecting sodium hypochlorite has been resolved by combining the system with the DCLPW pump series that features the air block mechanism and in-line type of automatic air-release mechanism.

3 reasons why the PTS system deals with gas locking effectively

- ① Layout where the pump is placed at the bottom to minimize the risk of air bubbles entering
- ② De-aerating joint that prevents air bubbles getting mixed in with the chemicals
- ③ Air released automatically even if air bubbles get mixed in with the chemicals



Every measure in place to ensure safety and peace of mind

Preventing tipping over



PTS-30

PTS-50-120

Tank-fixing portion for securing the tank is provided as a standard feature. There is no need to prepare a separate anchor plate or other parts for anchoring.*3

Preventing chemical spillage



The system has a large supply port that makes it easy to supply the chemicals and prevents spills.

The slanted construction ensures that no chemicals will collect on the top panel. An anti-drip guard protects the pump from the chemicals.

Preventing accidents before they happen



The supply port can be locked up using a padlock (option). The supplied chemical name seal prevents accidents caused by the use of wrong chemicals.

Protecting the pump from impact



The pump cover is provided as a standard feature. It protects the pump from external impacts, etc.

Preventing the entry of foreign matter



The large-diameter suction valve that supports two pumps comes with a strainer for protection from foreign matter and clogging.

*3 An anchor plate (option) for anchoring the system in the same position as the PTU series is available.

Model Code

PTS - **120** - **2** - **PW**

1 2 3

1 Tank capacity

30 : 30L
50 : 50L
120 : 120L

2 No. of pumps incorporated

Blank: one pump incorporated
2: two pumps incorporated*1

*1

Supported tanks: 50, 100
Supported pumps:

Series name	Model	Liquid-end part material
PW	30/60/100	VTCE/VTCF/VTCE
DCLPW	30/60/100	ATCF
DCPW	30/60/100	ATCF

The DCLPW does not come with a pump cover.

3 Incorporated pump models

PW series*2
DCLPW series
CLPW series
PZD series*2
PZI series*2
CS II series
SXDA series

*2 The tank and pumps are packed separately for the PW□-200, PZD series, and PZI series. Some pumps cannot be incorporated due to the liquid-end part material. For details, contact your TACMINA representative.

External Dimensions

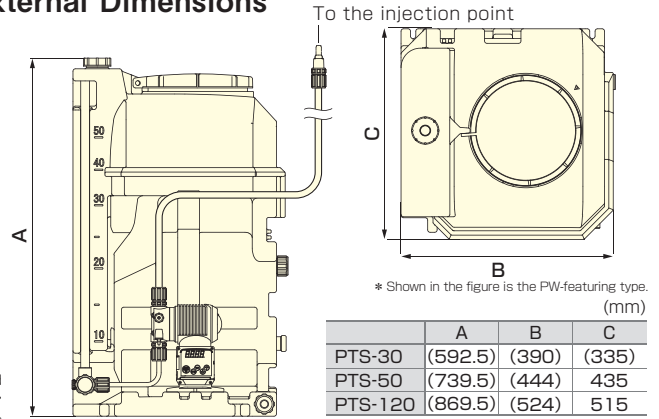

	A	B	C
PTS-30	(592.5)	(390)	(335)
PTS-50	(739.5)	(444)	435
PTS-120	(869.5)	(524)	515

Tank specifications

Model	PTS-30	PTS-50	PTS-120
Tank material	PE		
Tank capacity	30L	50L	120L
Seal material	EPDM or fluorocarbon rubber (selected to be compatible with the pump material)		
Weight (tank only)	4 kg	9 kg	15 kg

*Install a shade or other type of awning since exposure to direct sunlight or ultraviolet rays may cause discoloration and/or deterioration.

Accessories

	PTS-30/50/120
Anchor-fixing plain washers	4 pieces (PTS-50, 120 only)
Cable tie	1 piece
Chemical liquid name sticker	1 piece
Operating instructions	1 set
Incorporated pump accessories*1	1 set

*1 See the operation manual of the incorporated pump. This product does not come with a foot valve or strainer. A degassing joint is already attached to the DCLPW. A relief/air-release soft PVC hose is already attached to pumps that have a relief valve. Pump-mounting nuts/bolts are already attached to the PW200, PZD300/500, and PZI300/500. For the □PW, □PWT, and PZD, the signal cable is sold separately. For the □PWM, PZDP, PZDM, and PZI, the signal cable is included.

Corrosion resistance of tank (40°C or below)

Pumped liquid	Condition	Type of pump material recommended
Ammonia water	10%	VTCE
Hydrochloric acid	20%	VTCE
Hydrogen peroxide	30%(30°C)	VTCE
Sodium hydroxide	25%	VTCE
Sodium hypochlorite	12%	ATCF/CL
Poly aluminum chloride (PAC)	—	VTCE
Sulfuric acid	40%	VTCE
Aluminum sulfate	—	VTCE

*The components of boiler compounds differ by each manufacturer. For which materials are compatible and other such details, contact the chemicals manufacturer.

*Use chemicals that have a specific gravity of 1.3 or below. Using chemicals with a higher specific gravity may cause the tank to become deformed. Consult with Tacmina if chemicals with a specific gravity of more than 1.3 are to be used.

*Using chemicals that give off gases may adversely affect the surrounding areas.

*Tacmina selects the materials used for the liquid-end parts of the tank when the user has decided on the pump.

Options

● Float switch



A one-point- or two-point-type sensor informs the level of the remaining chemical liquid.

● Discharge volume checker



This monitors the injection operation, and outputs pulse signals.

● Drain cock



By simply twisting the cock, the chemicals will be discharged. This makes it easy to purge the chemicals safely.

● Padlock



This enables the supply port to be locked up.

● Flow indicator and photoelectric sensor



These make it possible to check the injection operation visually or using the sensor.

Related products



PC-PTS

Chemical injection system with built-in weekly timer

This system enables the injection of chemicals using timer operations, interval operations or pulse operations.



CB-PTS

Chemical injection system with built-in conductivity meter

By incorporating an interval timer function, the concentrations of chemicals can be managed and the injection of the chemicals can be controlled in a highly individualized manner.



PH-PTS

Chemical injection system with built-in pH (ORP) meter

The system delivers all the functions from measuring pH values to injecting and controlling the chemicals in a compact format.

TACMINA CORPORATION

Head Office:

2-2-14 Awajimachi, Chuo-ku, Osaka 541-0047 Japan
Tel.+81(0)6-6208-3974 Fax.+81(0)6-6208-3978
URL <http://www.tacmina.com>
E-mail trade@tacmina.com

Product designs and specifications are subject to change without notice for product improvement.

EC-051(4)04
2013/12/ASS



JQA-EM057 Production Department